

Citrix XenDesktop – Remote Access on iPads

To begin, go to the App Store and search for and download the 'Citrix Receiver' app.

Once installed, open Citrix Receiver and select 'Add Account'.

Enter your e-mail address, <username>@heathside.surrey.sch.uk, and click next and verify the connection. It will then ask you to enter your username and password. If asked to enter the 'domain', use **HEATHSIDE**.

Log on and you will see the list of applications available through Citrix remote access.

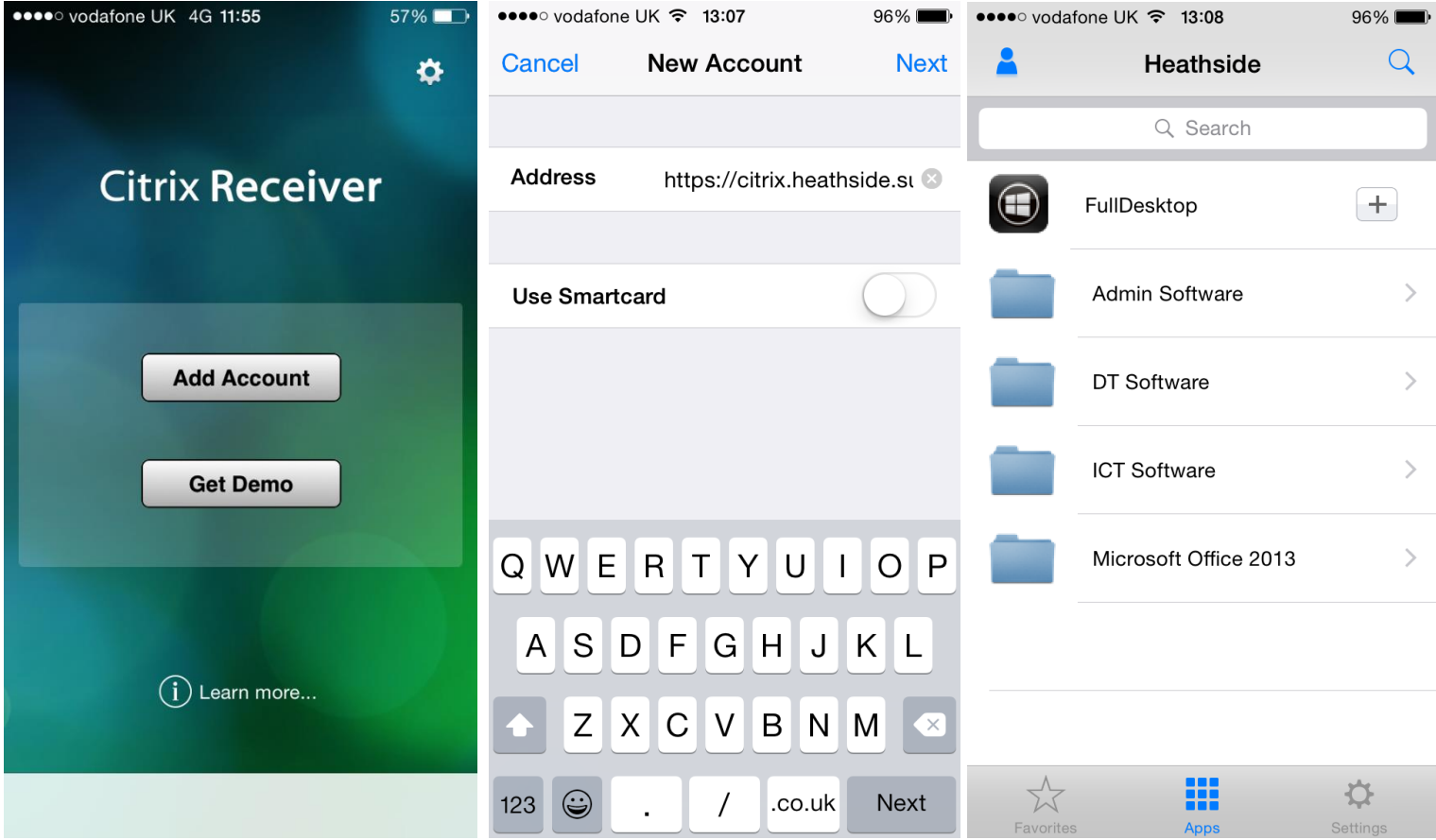

The Citrix Receiver app for iPad is optimised for touch and provides many advanced features that can be found under the 'Settings' menu.

You can adjust display options, customise keyboard shortcuts, and even set up a secondary iPad if you have one – using iOS's pairing functionality – to act as a makeshift trackpad for enhance dexterity!